

ROSE EXHIBIT SPONSORED BY THE HOUSTON ROSE SOCIETY

SATURDAY April 13, 2013
The Arbor Gate - 281-351-8851
15635 FM 2920
Tomball, Texas 77377

HOUSTON ROSE SOCIETY EXHIBIT CHAIRMAN

Exhibit Chairman Dan Lawlor
Volunteers

Prep time - 7:00 am to 9:30 am - We will use ARS tags.

**** Website - www.houstonrose.org**

Visit our website for latest information. This is an outdoor activity.

HORTICULTURE

ALPHABETICAL EXHIBIT SCHEDULE CLARIFICATION

Roses will be placed on exhibit table in alphabetical order in each general class. General classes will be expanded to create a subclass for each variety entered. Each separate variety will constitute a subclass.

STANDARD SPECIMEN ROSES

Class 1

HYBRID TEAS or GRANDIFLORAS and their climbing counterparts, one bloom per stem, no side buds.

Class 2

FULLY OPEN HYBRID TEAS or GRANDIFLORAS, one bloom per stem, no side buds, STAMENS MUST SHOW

Class 3

CLIMBING varieties, not sports of bush varieties, naturally grown.

Class 4

FLORIBUNDAS, one bloom per stem, no side buds.

Class 5

FLORIBUNDA, multiple blooms (3 or more) per stem.

Class 6

POLYANTHAS, multiple blooms (3 or more) per stem.

Class 7

SHRUB ROSES to include: Hybrid Musks, Rugosas, Hybrid Rugosas, any other shrub rose. These may be exhibited with side buds or disbudded, but can be only one stem of bloom(s).

Class 8

OLD GARDEN ROSES to include, Albas, Centifolias, Bourbons, Damasks, Autumn Damasks, Portlands, Gallicas, Hybrid Perpetuals, Mosses, Noisettes, Teas, Species, and any other old garden rose introduced PRIOR to 1867. These may be exhibited with side buds or disbudded, but can be only one stem of bloom(s). All entries should be named, registered and properly exhibited for the variety. Date of introduction, MUST be shown on upper right corner of entry tag.

Class 9

OLD GARDEN ROSES to include, Albas, Centifolias, Bourbons, Damasks, Autumn Damasks, Portlands, Gallicas, Hybrid Perpetuals, Mosses, Noisettes, Teas,

Species and any other Old Garden Roses introduced AFTER 1866, or those with UNKNOWN DATE OF INTRODUCTION. These may be exhibited with side buds or disbudded, but can be only one stem of bloom(s). All entries should be named, registered and properly exhibited for the variety. Date of introduction, if known, MUST be shown on upper right corner of entry tag.

MINIATURE SPECIMEN ROSES

Class 10

MINIATURE ROSES, bush and climbing types, one bloom per stem, no side buds.

Class 11

MINI-FLORA ROSES, bush and climbing types, one bloom per stem, no side buds.

Class 12

MINIATURE/MINIFLORA ROSE SPRAYS, bush and climbing types, multiple blooms (3 or more) per stem, no side buds.

Class 13

FULLY OPEN MINIATURE/MINIFLORA roses, one bloom per stem, no side buds. STAMENS MUST SHOW.

HYBRIDIZER

Hybridizers may enter as many seedlings as desired.

Class 14

HYBRIDIZER CHALLENGE - One stem of any unregistered seedling or sport hybridized or discovered by the exhibitor. Parentage must be identified on entry tag.

OTHER

Class 15

ROSE IN A BOWL - One rose, any standard variety, properly identified, displayed in brandy snifter furnished by Exhibit Committee. No foliage to show. Stage of opening to be determined by the exhibitor.

Class 16

HYBRID TEA ROSE COLLECTION - A bouquet of several Hybrid Teas, same variety or combination of varieties, one bloom per stem, no side buds, each variety correctly identified, exhibited in a container furnished by the exhibitor.

Class 17

OLD GARDEN ROSE COLLECTION - An entry of five (5) or more stems of Old Garden Roses with blooms, buds and/or hips, using not less than three varieties, with blooms predominating. All roses must be correctly identified. Container to be furnished by exhibitor.

Class 18

FRAGRANT ROSES: Open to Hybrid Teas, Grandifloras, Floribundas and Old Garden Roses, shown in exhibition stage or fully open. This class will be judged by the public.

Class 19

MINIATURE or MINIFLORA ROSE IN A BOWL - One (1) Miniature rose, correctly identified, displayed in a brandy snifter furnished by Exhibit Committee. No foliage to show. Stage of opening to be determined by exhibitor.

Class 20

UNKNOWN VARIETIES - Bring your roses to see if they can be identified.

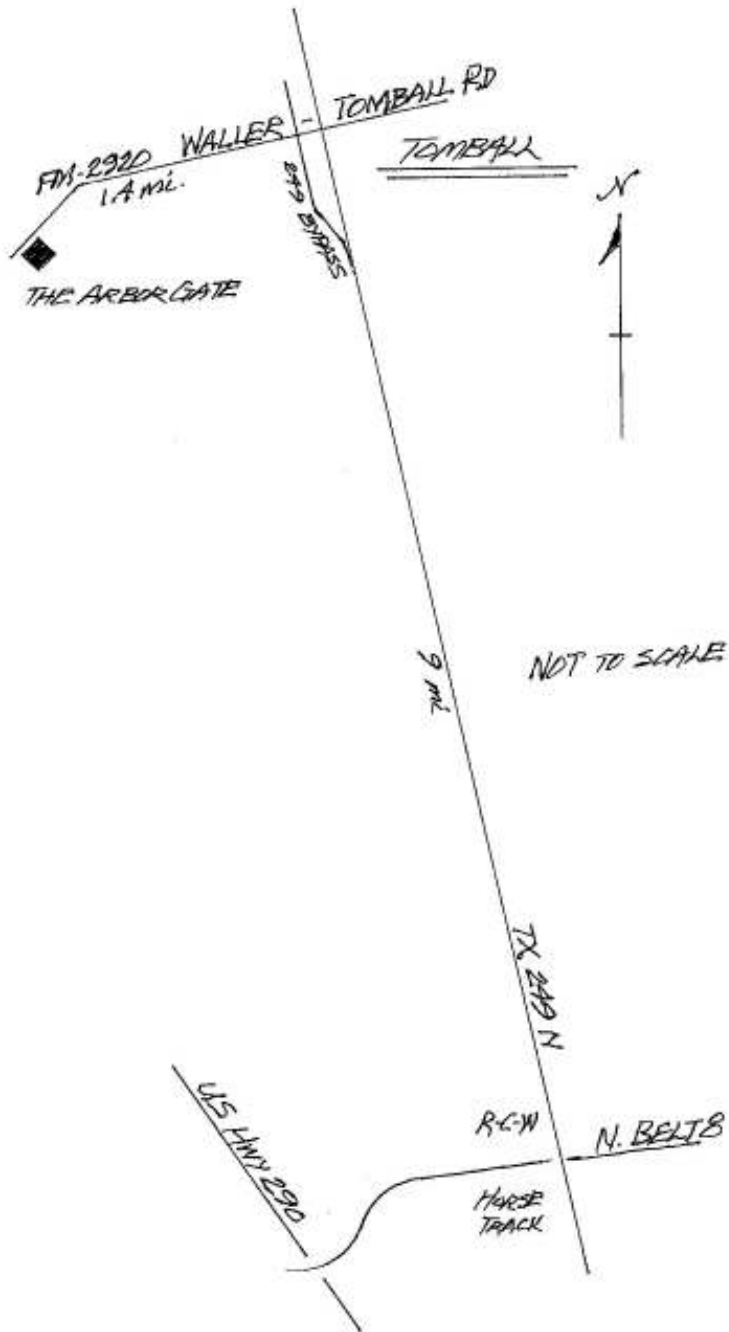

Map to Arbor Gate